

Timber Sale Invitation to Bid

Carol Sherwood Harvest

This is an invitation to place a lump sum bid for a **17 acre** timber sale located on a 40 acre property in the SE 1/4 of the NW1/4 of section 16, T37N R2E, Cheboygan County Michigan. The land is owned by Carol Sherwood. The timber sale is administered by Metcalfe Forestry. All bids must be turned in to Metcalfe Forestry before **5 pm Wednesday, May 22nd, 2019**.

Metcalf Forestry reserves the right to refuse any and all bids. Bid results will be available for all interested bidders. Please mail / fax / email all inquiries and bids to the address listed at the top of this page.

Unit 1 is a scotch pine clearcut. Unit 2 is a lowland aspen clearcut. Unit 3 is a selective harvest of high quality sugar maple. The total harvest volume is 328 cords and averages 19 cords per acre. 42% of the total volume is composed of logs and bolts and 58% of the volume is pulpwood.

The Sherwood property is best accessed from Riggsville Rd and north on Dow Rd which ends on the property. There are fields in the center of the property which can be used for landings.

Unit 3 is hilly but workable with mechanized equipment. Unit 2 is seasonally wet and may not be operable during the spring or fall. Unit 1 is flat and dry.

Payment: Ten percent of the sale value is to be paid up front within ten days of **when the contract is signed**. The harvest must be paid in full before beginning harvest operations.

Performance Guarantee: The buyer will be required to provide a performance guarantee in cash, check, or an irrevocable letter of credit from a bank for **\$1,000.00 to be paid up front when the contract is signed**.

Insurance: Prior to the start of any logging or road building, the buyer shall provide proof of Worker's Compensation Insurance as required by law, and Liability Insurance coverage in the amounts of \$250,000 per person and \$500,000 per incident. The buyer shall maintain this required insurance until completion of all logging activities on the property.

Volume Estimates: Sawlog volumes for sugar maple were determined by measuring 100% of the log trees being harvested. Volumes for all other species and products were determined by cruising 19 sample points with a 10 factor prism. All pulpwood was measured to a 4" top and sawlogs to an 11" top outside the bark, boltwood/spec wood to an 7" top outside bark. All products were measured 100 inches long. The tops of sawlog trees are included in the estimated pulpwood volume. The cruised volume estimate is calculated to have a statistical margin of error of plus or minus **24%**.

Carol Sherwood Harvest Summary 17 acres

Harvest Boundaries: are marked with Red paint.

Gate Combination: There is no gate on the property.

Timber to be harvested:

Unit 1: Harvest all Scotch Pine.

Unit 2: Harvest all trees except white cedar.

Unit 3: Harvest all ash and beech and trees marked with orange paint.

Special Considerations:

- Purchaser will drive on tree tops to reduce the likelihood of rutting.
- Whole tree skidding is not permitted on this sale.
- Purchaser shall take reasonable precautions to minimize unnecessary or excessive rutting. Excessive rutting is defined as ruts that are more than 12 inches deep and continue for more than 50 feet. Harvest operations should drive on tree tops to reduce rutting and should only occur during dry or frozen ground conditions.
- All saplings that are severely damaged or bent over during the harvest must cut down.

Harvest Timeframe: Timber harvesting operations must be completed by May 30th, 2021. Unit 3 cannot be harvested between April 15th and July 15th due to slippage season. **Harvesting timber during hunting season IS ALLOWED.** Cleanup operations must be done within two months of the end of harvest operations, or as soon as weather conditions allow.

Sugar Maple			Sugar Maple		
DBH	# logs	# of trees	DBH	# logs	# of trees
12	1	5	22	1	1
12	2	1	22	2	1
14	1	2	24	3	2
14	2	7	24	4	1
16	2	4	26	3	1
16	3	4	26	4	1
18	1	1	28	2	1
18	2	1	28	4	1
18	3	3	36	4	1
20	1	1		Total	44
20	2	2			
20	3	2			
20	4	1			

Carol Sherwood Harvest, 17 ACRES

Please use the following format to place your bid. The following volumes are not guaranteed by the Seller or Metcalfe Forestry Co.

Company Name:

The following is my lump sum bid for the Carol Sherwood Harvest. I have read and agree to the specific work requirements as written in the timber sale invitation to bid.

Sugar Maple	International 1/4 “ Logs	8.2 MBF	\$ _____
Basswood	Logs	16 cords	\$ _____
Aspen	Logs	19 cords	\$ _____
Mixed Hardwood	Bolts	36 cords	\$ _____
Mix Conifer	Bolts	46 cords	\$ _____
Mixed Hardwood	Pulp	66 cords	\$ _____
Dead Ash	Pulp	30 cords	\$ _____
Mix Conifer	Pulp	65 cords	\$ _____
Aspen	Pulp	30 cords	\$ _____

TOTAL LUMP SUM BID \$ _____

These bid prices are final and not subject to adjustment. Prospective bidders are urged to examine the timber sale before bidding. I understand that the estimated volume and grade of timber designated for cutting and removal is in no way guaranteed by the Seller or Metcalfe Forestry Co. I understand that any and all bids may be rejected.

Bidder's name & signature: _____

Telephone # / fax #: _____

Bidder's mailing address: _____

Bidder's email: _____

INVERNESS (W) T37N • R2W

SEE BEAUGRAND PAGE 51

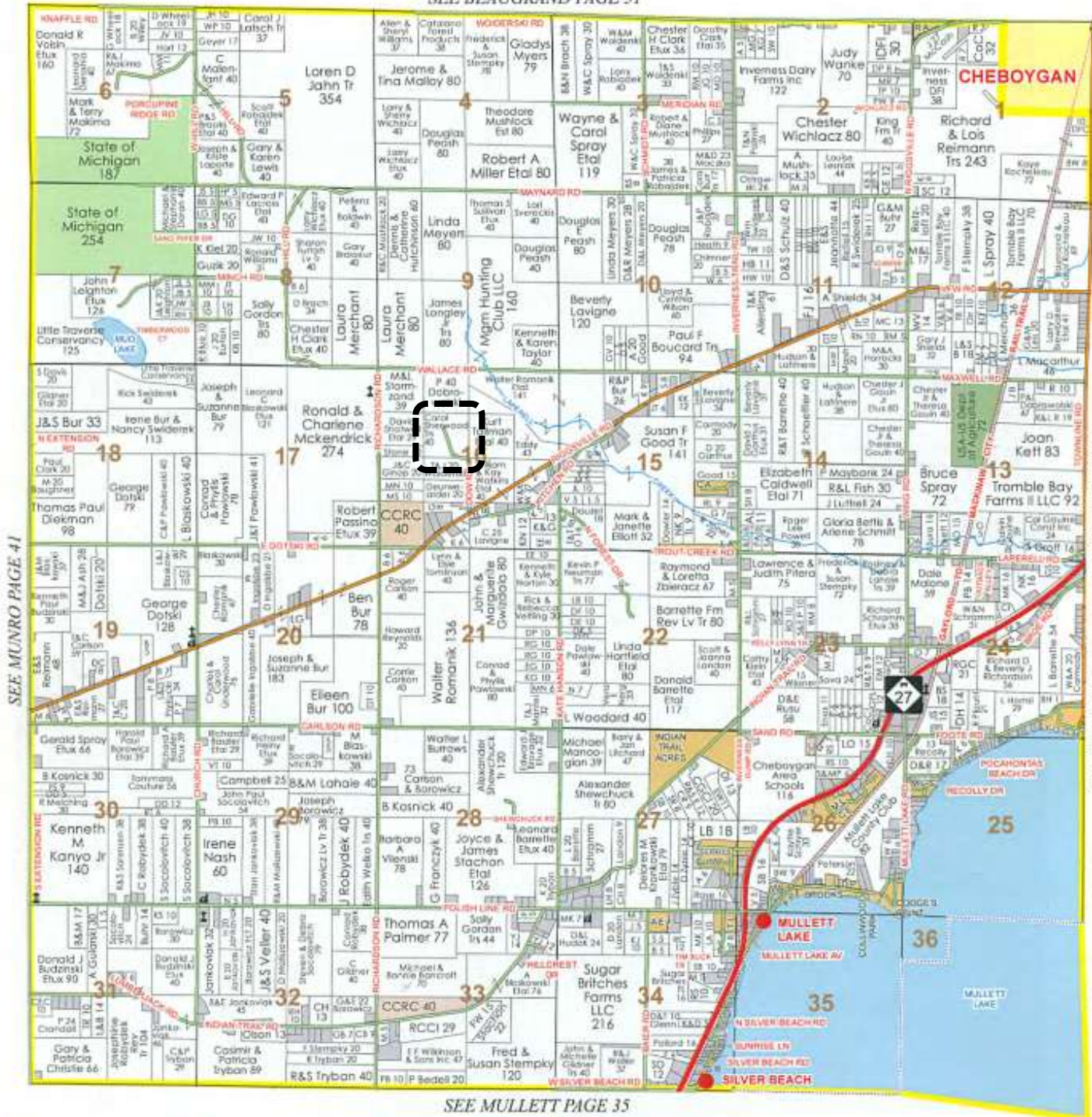

SEE MUNRO PAGE 41

SEE BENTON (SW) & INVERNESS (E) PAGE 45

Copyright © 2013 Mapping Solutions

SEE MULLETT PAGE 35

6000 5000 4000 3000 2000 1000 0

Sherwood Timberlands

Harvest Map

SE 1/4 of NW 1/4

Section 16

T37N-R2W

Cheboygan County, MI

Legend

-  Property Boundary
-  Unit Boundary



Map created April 2019
by Metcalfe Forestry
this is not a survey map

